



## HERCVLITE SERIES PANELS

**All the strength and security you have come to expect from VSI in a new lightweight format.**

### Hercvlite Series

**When space and weight are a major concern...**

**Class M** - 2" Thick 28 lbs. per sq. ft.  
\*Std. Panel Width 24"

**HERCVLITE IS THE ANSWER**

**Class I** - 2 1/4" Thick 32 lbs. per sq. ft.  
\*Std. Panel Width 24"

**\*NEW**

**Class II** - 3 1/2" Thick 49 lbs. per sq. ft.  
\*Std. Panel Width 24"

**\*NEW**

**Class III** - 6 1/2" Thick 91 lbs. per sq. ft.  
\*Std. Panel Width 24"

**\*NEW**

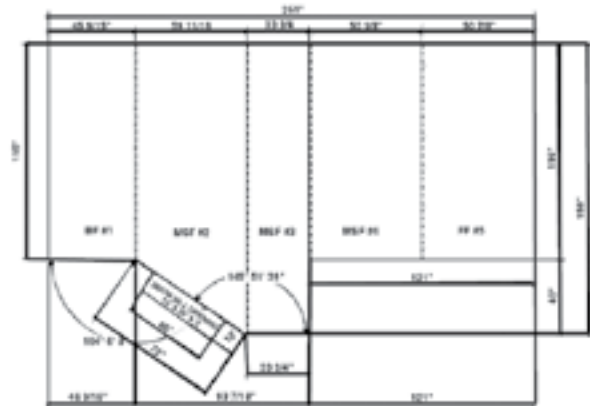

\*Smaller panel widths available at additional cost, consult sales for details.

## VSI - GET THE STRENGTH OF HERCVLITE

Since the introduction of modular vaults in the 70's there has been a need in the marketplace for a "concrete" lightweight vault panel in all U.L. classes. Lightweight panels are normally required for high-rise buildings and where heavy equipment cannot be used for the installation.

Lightweight vaults have been and are still produced using organic materials and metal. VSI is one of the few producers of this type of panel and will continue to manufacture these U.L. listed panels. The major reluctance in using these panels has been both their thickness and the hesitance to accept organic materials.

Not until recently have materials become available that would allow the manufacturing of both a thin and light weight version using "concrete." The "concrete" used for Hercvlite panels is UHPC or Ultra High Performance Concrete. Only recently has UHPC been able to be produced outside the laboratory. Using this blend enables our engineering staff to tailor the concrete allowing for the extremely durable, strong "concrete" required for security barriers while producing less volume. The process of both mixing and manufacturing these panels is extremely technical and requires an educated, dedicated and well-trained staff.

Although compressive PSI strength is only one factor to be considered concerning security of the panels, the Hercvlite panel has 2 - 2 1/2 times greater PSI than the AEGVS (concrete) series.

Naturally, there is a premium paid for both lightweight series in comparison to the AEGVS series. The flexibility of having suitable U.L. listed alternatives available will allow you to serve your customer and potentially make some sites more attractive.

With the widest choice of vault systems available, the latest technologies and the quickest turnaround time in the industry, is there any reason you should not consider VSI for your next vault need?



Manufacturer reserves the right to change product specifications without notice.



# HERCVLITE SERIES PANELS

## Safety, Strength & Dependability

*VSI's Hercvlite Class M panel is the thinnest modular vault panel on the market today.*

### VSI - WHY CHOOSE HERCVLITE?

Simple – Hercvlite offers all the dependability you have come to know from Vault Structures' modular vault panels, combined with ultra high performance concrete in a lighter, thinner model.

Security has just become thinner, lighter and stronger all at the same time. Hercvlite is the future of modular vault panels and it is available now from Vault Structures, Inc. Call now for your quote!

### TOP FEATURES

- U.L. Rated: Class M, Class I, Class II, and Class III
- Panels are thinner than the Aegvs Series & Vision Series
- Panels weigh less than Aegvs Series panels
- Panels are made using Ultra High Performance Concrete.

	HERCVLITE	VISION	AEGVS
U.L. CLASS	HERCVLITE SERIES UHPC	VISION SERIES ORGANIC TRADITIONAL	AEGVS SERIES CONCRETE TRADITIONAL
	Thickness / lbs. per sq. ft.	Thickness / lbs. per sq. ft.	Thickness / lbs. per sq. ft.
M	2" 28 lbs.	3 1/2" 19 lbs.	3" 40 lbs.
*NEW 1	2-1/4" 32 lbs.	5 1/2" 25 lbs.	4" 55 lbs.
*NEW 2	3-1/2" 49 lbs.	10 1/2" 44 lbs.	6" 82 lbs. *NEW
*NEW 3	6-1/2" 91 lbs.	12" 75 lbs.	9" 125 lbs. *NEW

Note: The standard panel length limit is set at 14' for all classes due to access and installation considerations.



Manufacturer reserves the right to change product specifications without notice.